

# BorderPatrol MB PSU / Puresound A30 Installation Manual



Puresound A30



**BorderPatrol**

## **Installation instructions: Use in combination with the pictures and diagrams on pages 4-6**

- 1. Disconnect the amplifier from the mains and allow to cool for 15mins.**
- 2. Remove the valves and the bottom cover.**
- 3. Locate the 3 WHITE high voltage wires that connect from the power transformer to the PCB. See picture.**
- 4. De-solder these wires and insulate using heat shrink tubing. Make sure these wires are insulated and cannot make contact with anything inside the amplifier.**
- 5. Locate the choke/inductor.**
- 6. De-solder and insulate the Red wire connecting the choke to the PCB.**
- 7. Drill a 10mm hole on the back chassis panel between the fuse and the 8ohm speaker terminal. Be very careful not to damage anything inside the amplifier when drilling.**
- 8. Fit the cable gland supplied and feed through the BorderPatrol connection cable.**
- 9. Solder the RED wire to the point previously used by the Red choke wire.**
- 10. Solder the GREEN wire to the resistor leg shown on the diagram close to the 330uF electrolytic capacitor**
- 11. Solder the BLUE wire to Pin7 of the 6550 valve socket as shown on the diagram**
- 12. Solder the YELLOW wire to Pin2 of the 6550 valve socket as shown on the diagram.**
- 13. Check your work. Make sure the insulation of the 3 WHITE wires is secure and safe. Dress the new cables using a cable tie.**
- 14. Re-fit the valves. The central valves are no longer being used can also be re-fitted if you feel the look of the amplifier is improved.**
- 15. Connect to the BorderPatrol PSU. Fit mains cable to both units and switch on.**
- 16. With a multimeter, measure the voltage at the point where the RED wire from the BorderPatrol connection cable connects to the PCB. The voltage should read approx 410V.**

**If everything measures correctly, the amplifier is now be ready to play. Refit the bottom cover and enjoy!**

Disconnection of Puresound  
A30 PSU



De-solder, remove and  
insulate the 3 white  
wires.





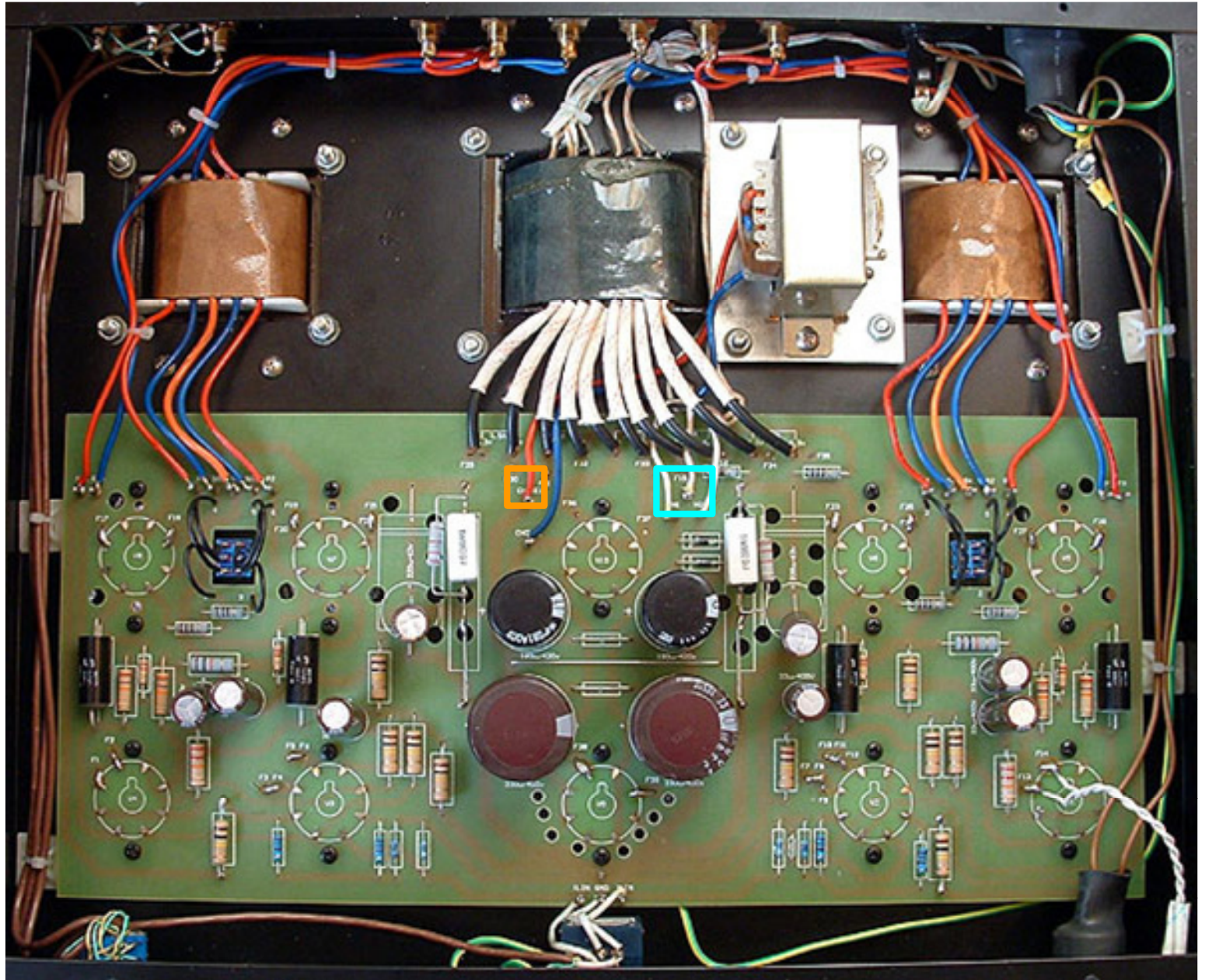

De-solder, remove and  
insulate the red wire.



**Border**Patrol

## Connection of BorderPatrol PSU

-  Solder the Red wire to the tag where the red wire from the choke was previously connected.
-  Solder the Blue wire to Pin 7 of the 6550 socket.
-  Solder the Yellow wire to Pin 2 of the 6550 socket.
-  Solder to the leg of the resistor close to the brown 330uF capacitor as shown.

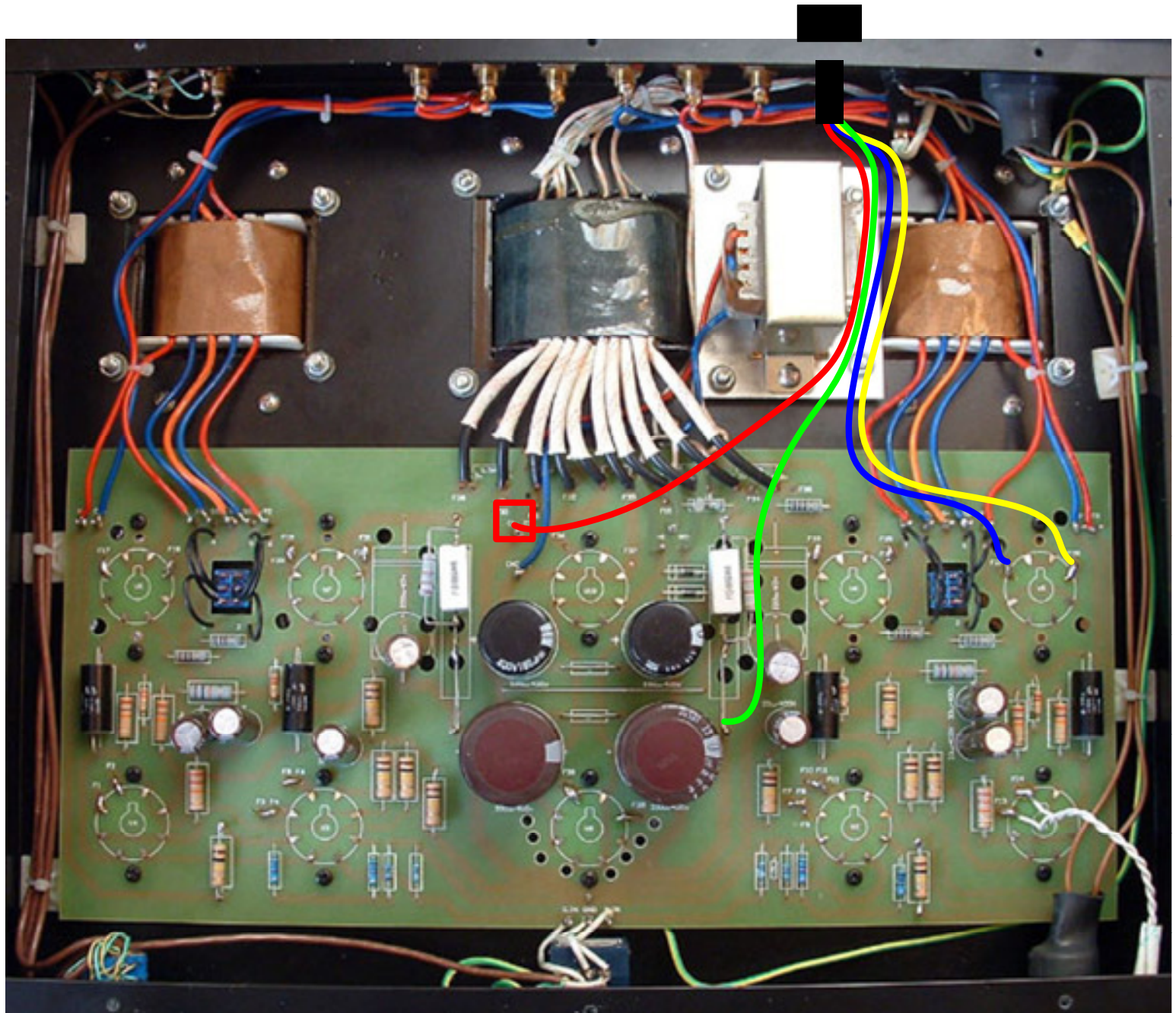

**Border**Patrol

# Borderpatrol PSU installation instructions for PureSound A30 amplifier

## PureSound A30 high voltage supply

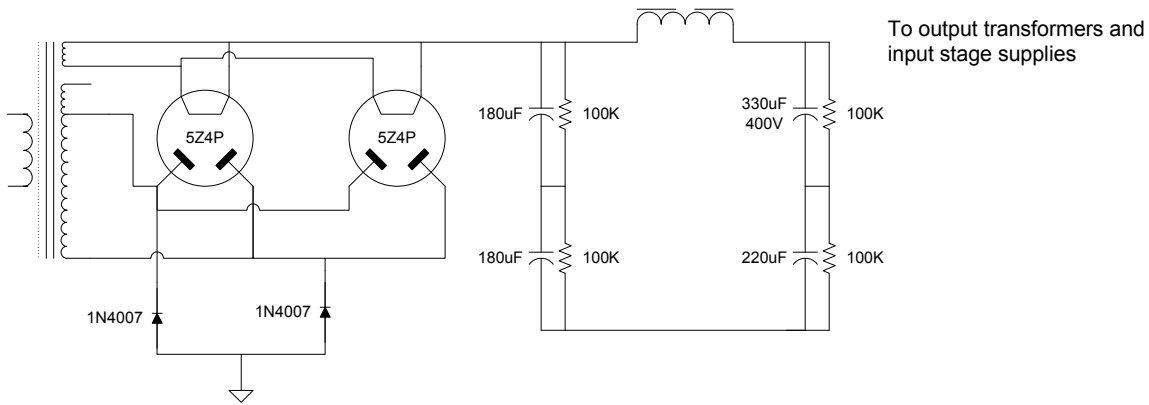

## Disable A30 high voltage supply

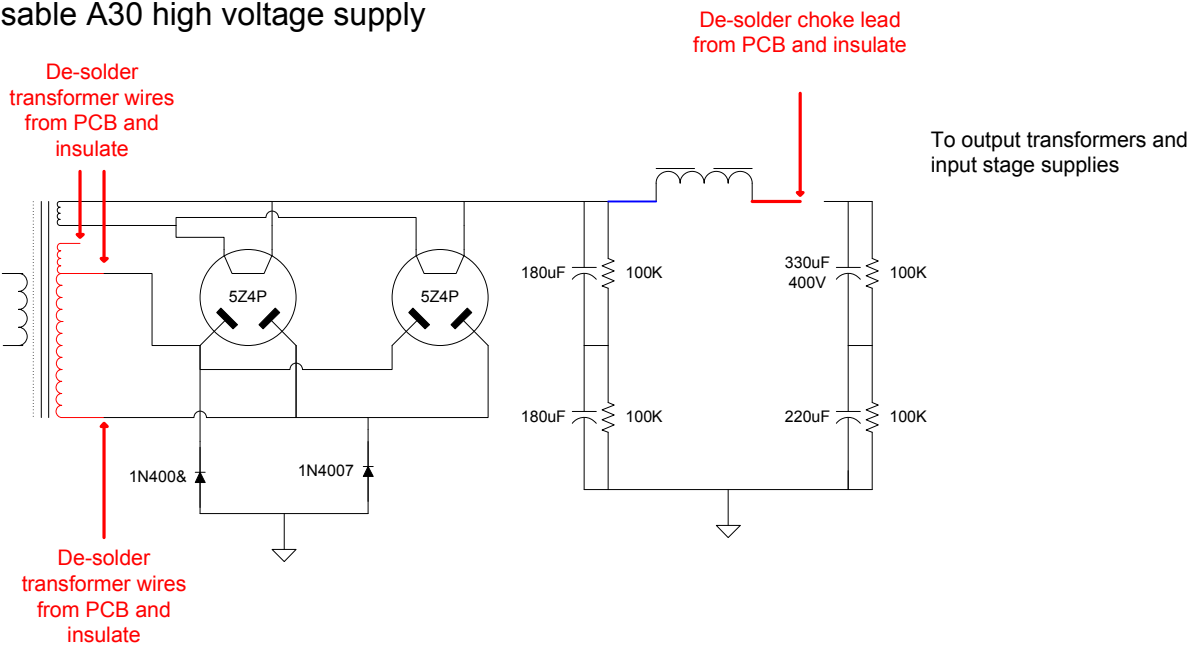

## Connect BorderPatrol PSU

